

Inspection Report (<input checked="" type="checkbox"/> 1ST <input type="checkbox"/> 2ND)		PENDING
<input checked="" type="checkbox"/> Pre-shipment <input type="checkbox"/> ON-LINE <input type="checkbox"/> IN PROCESS <input type="checkbox"/> FULL		
Summary Section		Service Number: F-QC 2502241657030857
	ProductName	Oven
	Itemnumber	GA12S-01/GA13S-01/GA22S-01
	P/Onumber	---
	Quantity	300pcs+300pcs+500pcs=1100pcs
	Clientname	---
	Suppliername	---
	Inspectiondate	2025-02-27
	Inspectionlocation	ZhongshanGuangdongChina

INSPECTOR	
<p> 中山烁仕技术服务中心 Golux Technology & Service Center 中山市高乐士电器制造有限公司 Zhongshan Golux Electrical Appliances Ltd. </p>	
Inspector: Gavin Zhong	Inspector in factory / Inspector en la fabrica
Arrival time at the factory / Llegada a fabrica	Departure time from the factory / Salida de fabrica
14:30PM	19:40PM

Category	Con form		Comment
1. Quantity	<input checked="" type="checkbox"/> YES	<input type="checkbox"/> NO	
2. Product description / style / color	<input type="checkbox"/> YES	<input checked="" type="checkbox"/> NO	Special attention 1
3. Workmanship	<input checked="" type="checkbox"/> YES	<input type="checkbox"/> NO	
4. Testing/ checking	<input type="checkbox"/> YES	<input checked="" type="checkbox"/> NO	Special attention 2.4
5. Data measurement	<input checked="" type="checkbox"/> YES	<input type="checkbox"/> NO	
6. Packaging	<input type="checkbox"/> YES	<input checked="" type="checkbox"/> NO	Special attention 3
7. Marking	<input type="checkbox"/> YES	<input checked="" type="checkbox"/> NO	3

OVERALL SUGGESTION	P ENDING
	Pending client review and approval

Special Attention				
1> No sample was approved for reference. 2> The factory refused to do the carton drop test. 3> The factory only supplied French fries for product usability test. 4> Nopackaginginformationandlabelinformationforreferenceinspection.				
Defectiveproducts	<input checked="" type="checkbox"/> pickout	<input type="checkbox"/> replace	<input type="checkbox"/> rework	

DETAILS

Quantity

Item	Ordered quantity	Total carton	Packed Quantity	Finished quantity	Sample Qty. AQL	DEFE CT S			Comment
						Cri	Maj	Min	
The inspection quantity for the whole order is according to inspection level III,for each item is according to the inspection level I.						0.0	1.5	4.0	
						0	5	10	
Total	1100	1100	1100	1100	125	0	0	5	
GA12S-01	300	300	300	300	34	0	0	1	
GA13S-01	300	300	300	300	34	0	0	2	
GA22S-01	500	500	500	500	57	0	0	2	

Inspection Standard: ANSI/ASQZ1.4 (MIL-STD-105E)			DEFE CT S		
Inspection Level: sample size has been determined			Critical	Major	Minor
Samplingplan: Single, Normal		AQL	0.0	1.5	4.0
Ordered Qty	SampleSize:	Max.Allowed:	0	5	10
1100	125	DefectsFound:	0	0	5

Defects Found			
Defectives Description	CRI	MAJ	MIN
1. Dirty mark	0	0	3
2. Scratch mark	0	0	2

Defectives PIC



Dirty mark-minor



Dirty mark-minor

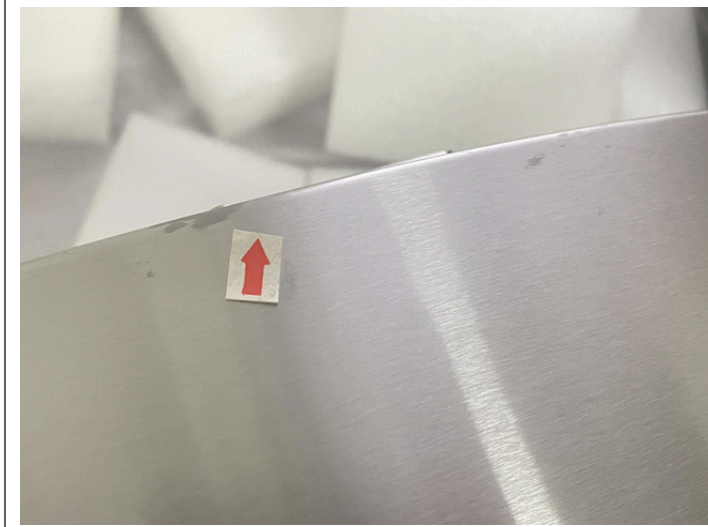

Dirty mark-minor



Scratch mark-minor



Scratch mark-minor

NA

NA

List of test data

Item	Contract requirements	Measured data
GA12S-01		
Carton size	36x33x37.3cm	36x33.4x37.5cm
G.W.	5.5kg	5.3kg
Product size	N/A	31.7x30.3x32.7cm
Product weight	N/A	4.5kg
GA13S-01		
Carton size	36x33x37.3cm	35.6x33.4x37.5cm
G.W.	5.5kg	5.3kg
Product size	N/A	30.5x28.5x31.4cm
Product weight	N/A	4.5kg
GA22S-01		
Carton size	36x33x37.3cm	36x33.4x37.6cm
G.W.	5.5kg	5.2kg
Product size	N/A	31.3x28.5x30.5cm
Product weight	N/A	4.4kg

GA12S-01









ENGLISH
 WARNING: PLASTIC BAGS CAN BE DANGEROUS. TO AVOID DANGER OF SUFFOCATION, KEEP THIS BAG AWAY FROM BABIES AND CHILDREN.

FRENCH
 ATTENTION: LES SACS EN PLASTIQUES PEUVENT ETRE DANGEREUX. POUR EVITER LE DANGER DE SUFFOCATION, NE LAISSEZ PAS CE SAC A LA PORTEE DES BEBES NI DES ENFANTS.

DUTCH
 WAARSCHUWING: PLASTIC ZAKKEN KUNNEN GEVAARLIJK ZIJN. ER BESTAAT VERSTIKKINGSGEVAAR. HOUD DAAROM DEZE ZAK UIT DE BUURT VAN BABY'S EN KLEINE KINDEREN.

SLOVENIAN
 OPOZORILO: PLASTICNE VRECKE SO LAHKO NEVARNE, KER SE LAHKO OTROCI Z NJIMI ZADUSIJO. ZARADI TEGA TO VRECKO ODSTRANITE IZ DOSEGA DOJENCKOV IN MAJHNH OTROK.

FRENCH
 ATTENTION: LES SACS EN PLASTIQUES PEUVENT ETRE DANGEREUX. POUR EVITER LE DANGER DE SUFFOCATION, NE LAISSEZ PAS CE SAC A LA PORTEE DES BEBES NI DES ENFANTS.

GERMAN
 WARNUNG: PLASTIKBEUTEL KÖNNEN GEFÄHRLICH SEIN. ES BESTEHT ERSTICKUNGSGEFAHR. HALTEN SIE DESHALB DIESEN BEUTEL VON BABYS UND KLEINKINDERN FERN.

SLOVENIAN
 OPOZORILO: PLASTICNE VRECKE SO LAHKO NEVARNE, KER SE LAHKO OTROCI Z NJIMI ZADUSIJO. ZARADI TEGA TO VRECKO ODSTRANITE IZ DOSEGA DOJENCKOV IN MAJHNH OTROK.

DANISH
 ADVARSEL: PLASTICPOSER KAN VÆRE FARLIGE DER ER FARE FOR KVÆLNING. HOLD DERFOR DENNE POSE VÆK FRA SPÆDBØRN OG SMÅBØRN

SLOVENIAN
 OPOZORILO: PLASTICNE VRECKE SO LAHKO NEVARNE, KER SE LAHKO OTROCI Z NJIMI ZADUSIJO. ZARADI TEGA TO VRECKO ODSTRANITE IZ DOSEGA DOJENCKOV IN MAJHNH OTROK.

ADVARSEL:
 PLASTICPOSER KAN VÆRE FARLIGE DER ER FARE FOR KVÆLNING. HOLD DERFOR DENNE POSE VÆK FRA SPÆDBØRN OG SMÅBØRN

SPANISH
 ADVERTENCIA: LAS BOLSAS DE PLÁSTICO PUEDEN SER PELIGROSAS. EXISTE PELIGRO DE ASFIXIA. POR ESO, MANTENGA ESTA BOLSA FUERA DEL ALCANCE DE BEBÉS Y NIÑOS.

PORTUGUESE
 ADVERTENCIA: SACOS DE PLÁSTICO PODEM SER PERIGOSOS. EXISTE PERIGO DE ASFIXIA. POR ISTO, MANTENHA ESSE SACO FORA DO ALCANCE DE BEBÉS E CRIANÇAS.

02
PE

WAARSCHUWING:
 PLASTIC ZAKKEN KUNNEN GEVAARLIJK ZIJN. ER BESTAAT VERSTIKKINGSGEVAAR. HOUD DAAROM DEZE ZAK UIT DE BUURT VAN BABY'S EN KLEINE KINDEREN.

OPOZORILO:
 PLASTICNE VRECKE SO LAHKO NEVARNE, KER SE LAHKO OTROCI Z NJIMI ZADUSIJO. ZARADI TEGA TO VRECKO ODSTRANITE IZ DOSEGA DOJENCKOV IN MAJHNH OTROK.

ITALIAN
 ATTENZIONE: I SACCHETTI DI PLASTICA POSSONO ESSERE PERICOLOSI. PERICOLO DI SOFFOCAMENTO. TENERE I SACCHETTI LONTANI DALLA PORTATA DEI BAMBINI.

SPANISH
 ADVERTENCIA: LAS BOLSAS DE PLÁSTICO PUEDEN SER PELIGROSAS. EXISTE PELIGRO DE ASFIXIA. POR ESO, MANTENGA ESTA BOLSA FUERA DEL ALCANCE DE BEBÉS Y NIÑOS.

02
PE

PERICOLOSI:
 AMENTO. LONTANI AMBINI.

PUEDEN SER PELIGROSAS. EXISTE PELIGRO DE ASFIXIA. POR ESO, MANTENGA ESTA BOLSA FUERA DEL ALCANCE DE BEBÉS Y NIÑOS.

EXISTE PERIGO DE ASFIXIA. POR ISTO, MANTENHA ESSE SACO FORA DO ALCANCE DE BEBÉS E CRIANÇAS.

02
PE





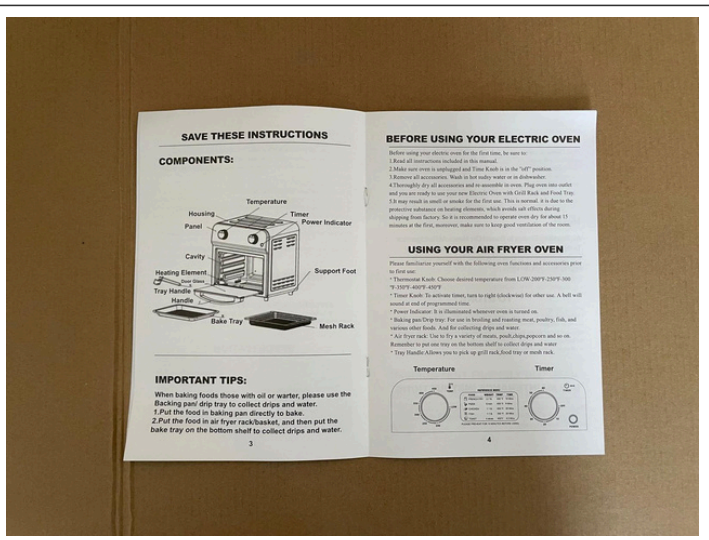
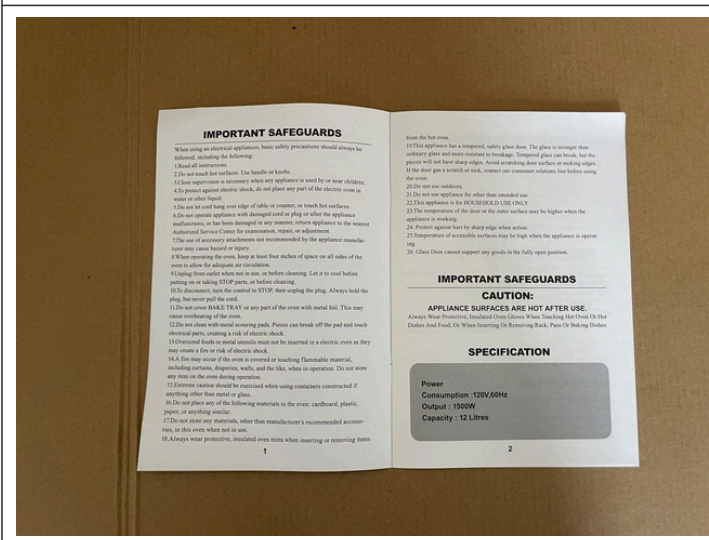
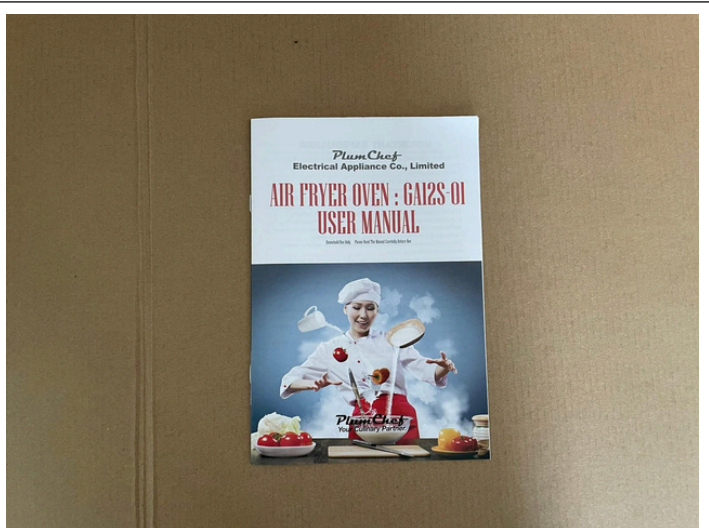
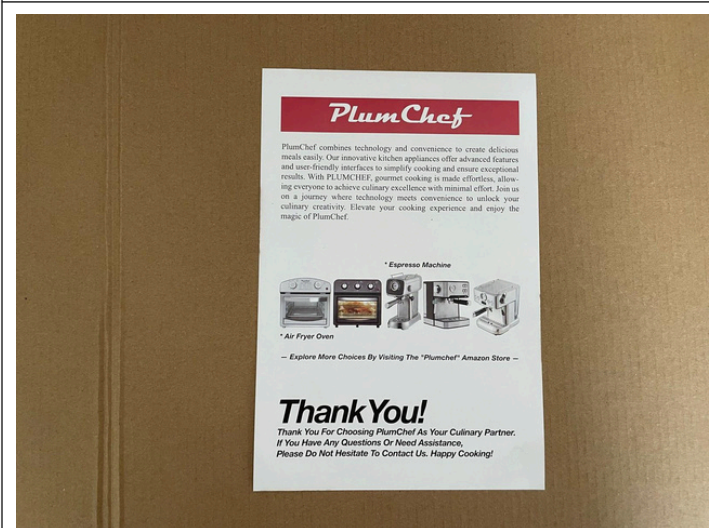

OPERATION

- Place food to be cooked directly in Baker Tray or on rack - per it in the oven and close the oven door.
- Select proper temperature by the Temperature Knob.
- Preheat proper cooking time and start the oven. Timing accordingly and checking progress with area thermometer to assure desired doneness.
- Make sure to turn Timer Knob to "0" to turning off the oven when cooking is completed.

Note:
 All Toasting Timing is Based On Meats At Refrigerator Temperature. Frozen Meats May Take Considerably Longer. Therefore, Use Of A Meat Thermometer is Highly Recommended.

TO STORE

Unplug unit, allow to cool, and clean before storing. Store Toaster Oven in its box in a clean, dry place. Never store appliance while it is hot or still plugged in. Never wrap cord tightly around the appliance, use the Cord Storage area on the bottom of the back of the unit. Do not put any stress on the cord where it enters the unit, as it could cause the cord to fray and break.

USE MAINTENANCE INSTRUCTIONS

This appliance requires little maintenance. It contains no user serviceable parts. Do not try to repair or rework. Contact a qualified appliance repair technician if the product requires servicing.

CLEANING INSTRUCTIONS

ALWAYS UNPLUG OVEN AND ALLOW TO COOL BEFORE CLEANING TO PROTECT AGAINST THE RISK OF ELECTRICAL SHOCK. DO NOT IMMERSIVE THE UNIT, CORD OR PLECS IN WATER OR OTHER LIQUID.

YOUR OVEN FEATURES A COOK-CLEAN COATING. IF BURNED, WIPE WALLS WITH DAMP CLOTH MOISTENED WITH MILD DETERGENT.

DO NOT USE STEEL WOOL, SCOURING PADS OR ABRASIVE CLEANERS OR SCRAPER WALLS WITH METAL UTENSILS, AS THIS MAY DAMAGE THE COOK-CLEAN INTERIOR.

WASH ALL ACCESSORIES IN HOT SUDSY WATER OR IN A DISHWASHER. WIPE THE DOOR WITH A CLEAN DAMP CLOTH, AND DRY WITH A PAPER OR CLOTH TOWEL. CLEAN EXTERIOR WITH DAMP CLOTH.

DO NOT USE AN ABRASIVE CLEANER, AS IT MAY DAMAGE THE EXTERIOR FINISH.

DO NOT USE AN ABRASIVE CLEANER OR STEEL WOOL SCOURING PAD ON DRIP PAN, AS IT MAY DAMAGE THE PORCELAIN ENAMEL FINISH.

DRY ALL PARTS AND SURFACES THOROUGHLY PRIOR TO PLEGGING OVEN IN AND USING.

ENVIRONMENT FRIENDLY DISPOSAL

Disposal: do Not Dispose This Product As Unsorted Municipal Waste. Collection Of Such Waste Separately For Special Treatment is Necessary.

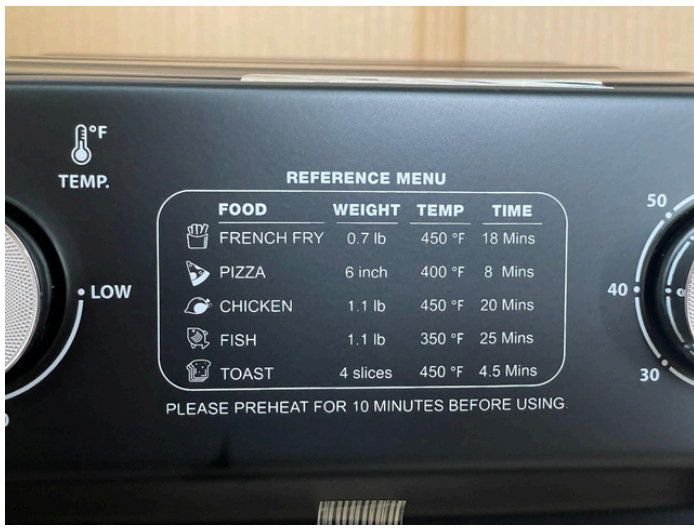



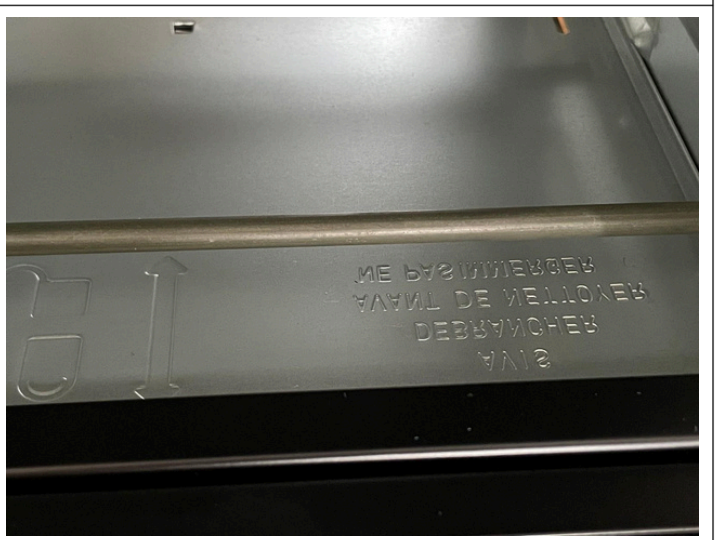





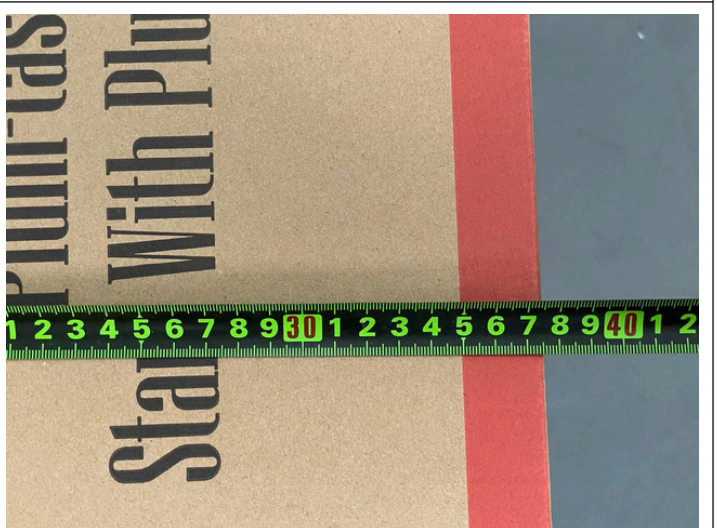

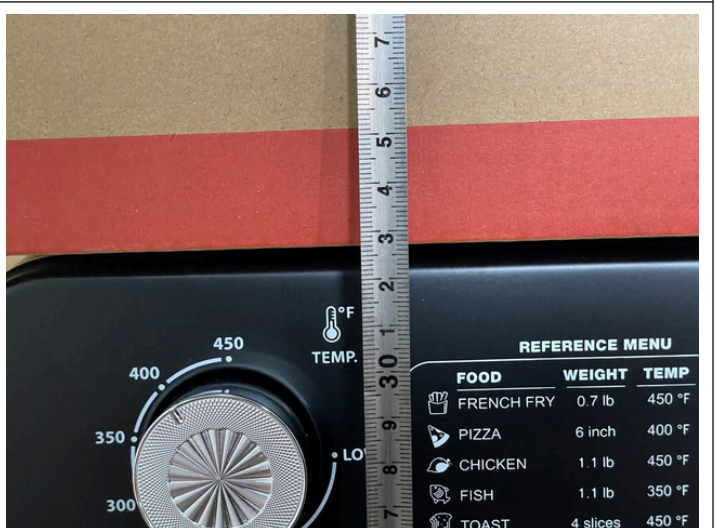



GA13S-01





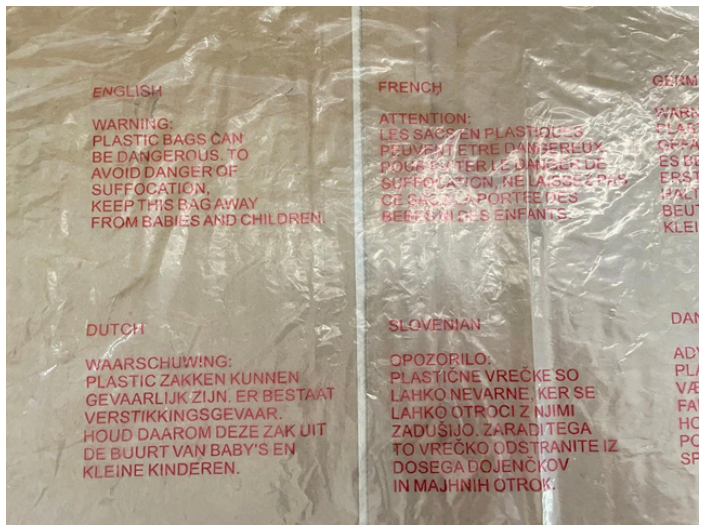

ENGLISH
 WARNING:
 PLASTIC BAGS CAN
 BE DANGEROUS TO
 AVOID DANGER OF
 SUFFOCATION,
 KEEP THIS BAG AWAY
 FROM BABIES AND CHILDREN.

FRENCH
 ATTENTION:
 LES SACS EN PLASTIQUE
 PEUVENT ETRE DANGEREUX
 POUR ENFANTS EN RISQUE DE
 SUFFOCATION. NE LASSEZ PAS
 CE SAC A PORTEE DES
 BEBES ET DES ENFANTS.

GERMAN
 WARNUNG:
 PLASTIK
 BEUTELCHEN
 KÖNNEN
 ERSTICKUNGS-
 GEFAHRE
 BEI KLEINEN
 KINDERN
 DARSTELLEN.
 HALTEN SIE
 DIESE BEUTELCHEN
 VON KLEINEN
 KINDERN
 FERN.

DUTCH
 WAARSCHUWING:
 PLASTIC ZAKKEN KUNNEN
 GEVAARLIJK ZIJN. ER BESTAAT
 VERSTIKKINGSGEVAAR.
 HOUD DAAROM DEZE ZAK UIT
 DE BUURT VAN BABY'S EN
 KLEINE KINDEREN.

SLOVENIAN
 OPOZORILO:
 PLASTICNE VRECKE SO
 LAHKO NEVARNE, KER SE
 LAHKO OTROCI Z NJIMI
 ZADUSIJO. ZARADITEGA
 TO VRECKO ODSRANITE IZ
 DOSEGA DOJENČKOV
 IN MAJHNIH OTROK.

DANISH
 ADVARSEL:
 PLASTIK
 BEUTELCHER
 KAN VÆRE
 FARLIGT
 FOR
 SMÅ BØR
 OG
 SMÅ BØR
 SKAL
 HOLDES
 FRA.
 BEHOLD
 DENNE
 BEUTELCHER
 FRA
 SMÅ BØR
 OG
 SMÅ BØR
 SKAL
 HOLDES
 FRA.

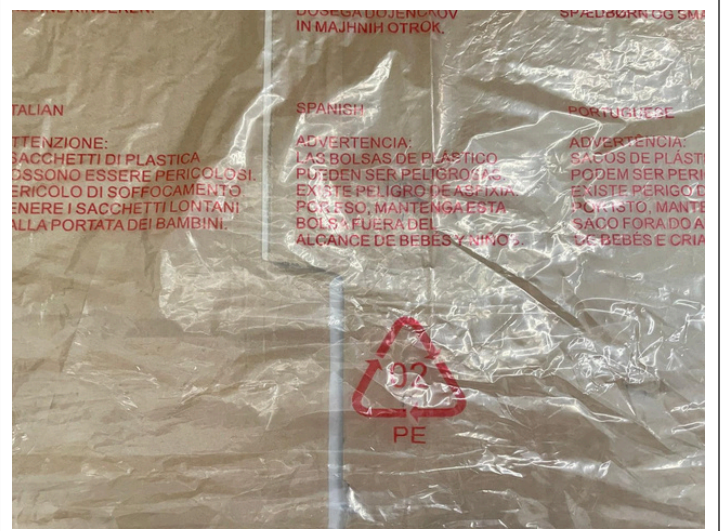
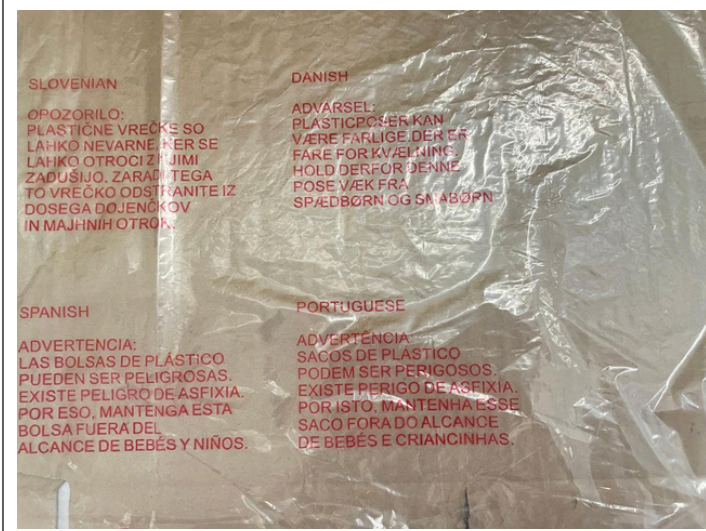
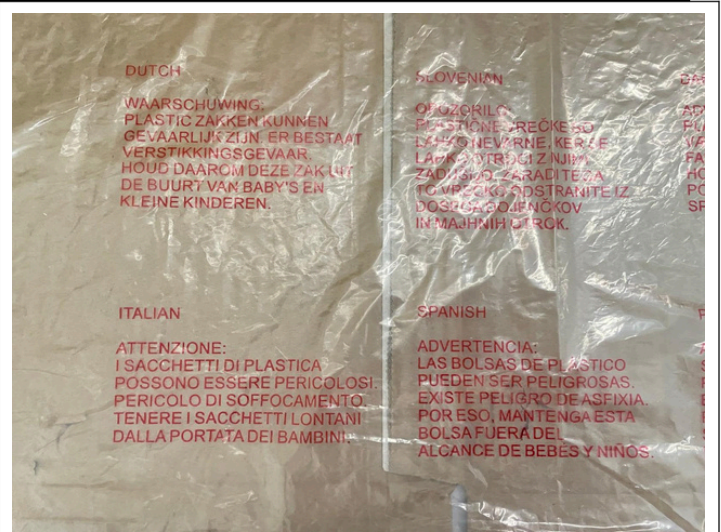
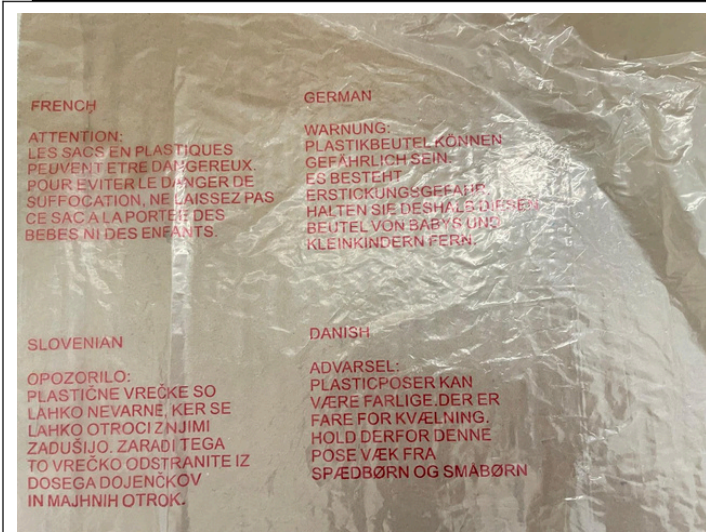





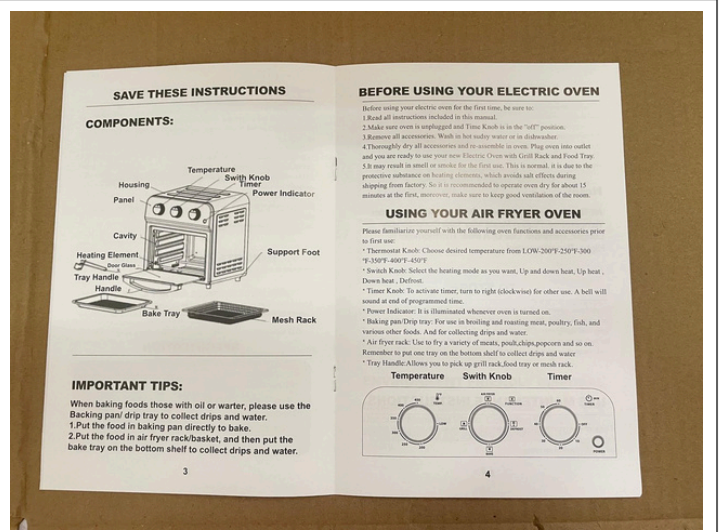

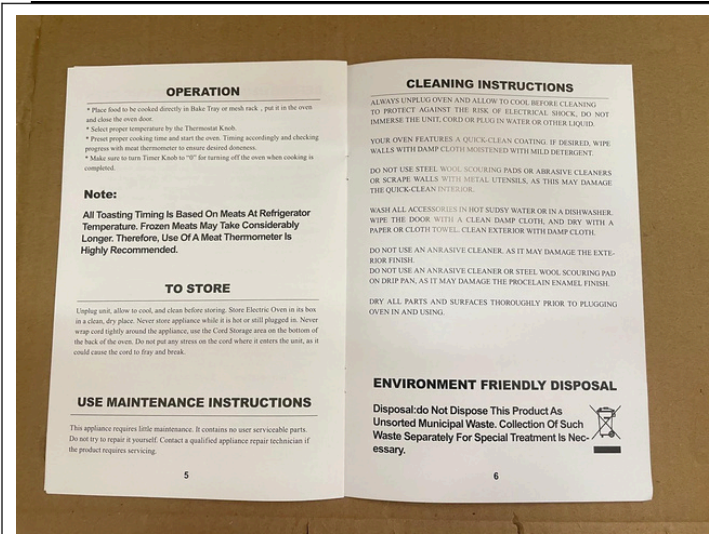





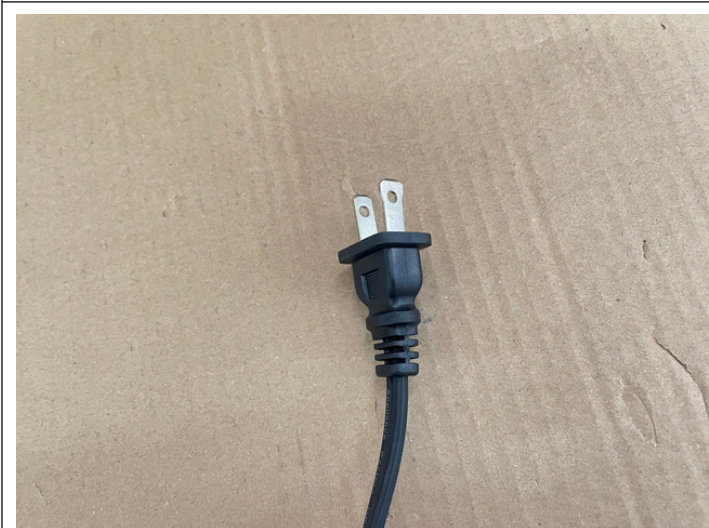

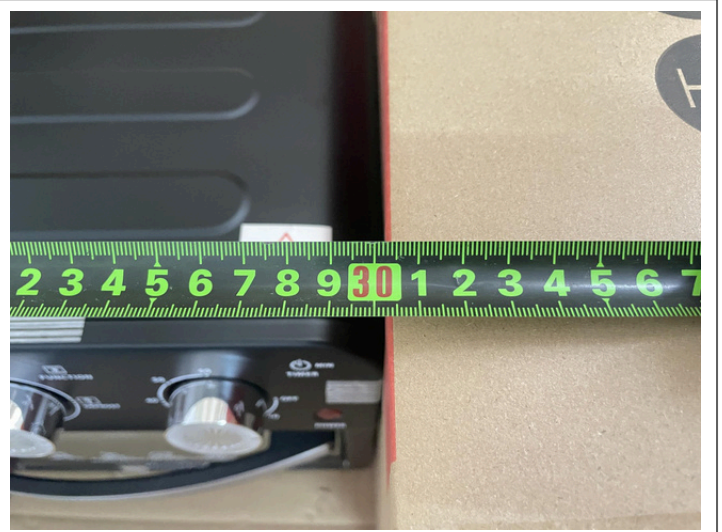
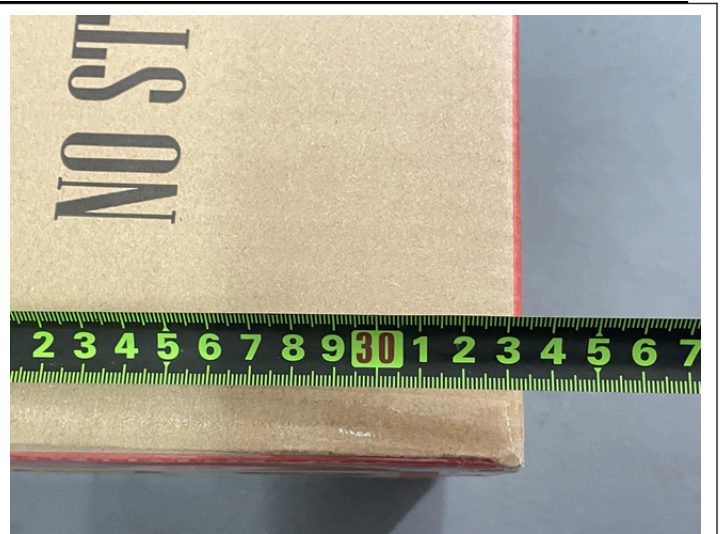

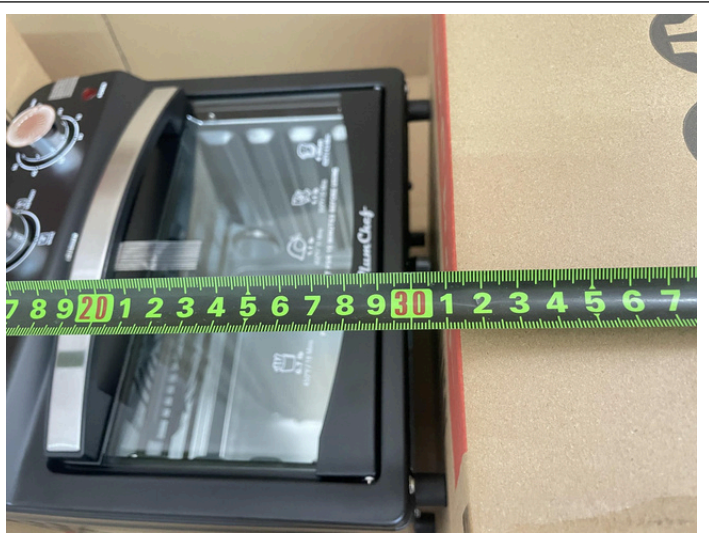



GA22S-01



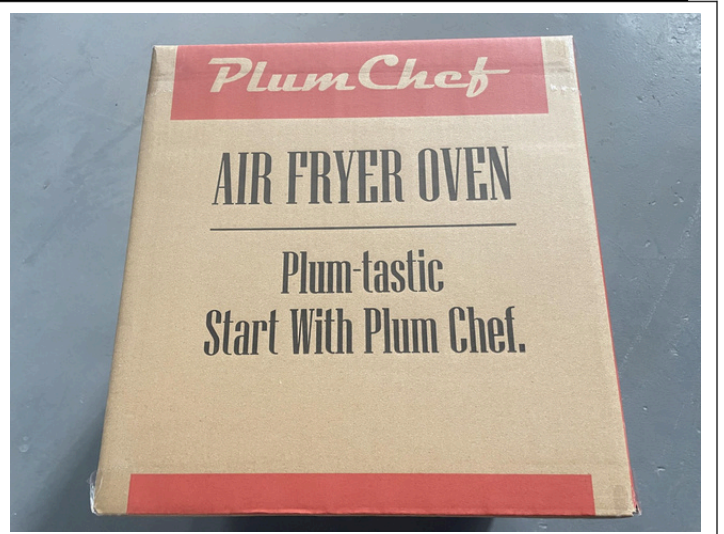



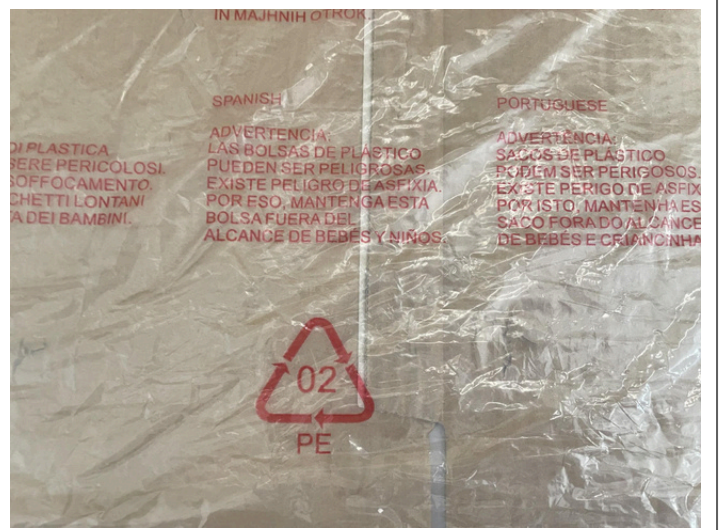
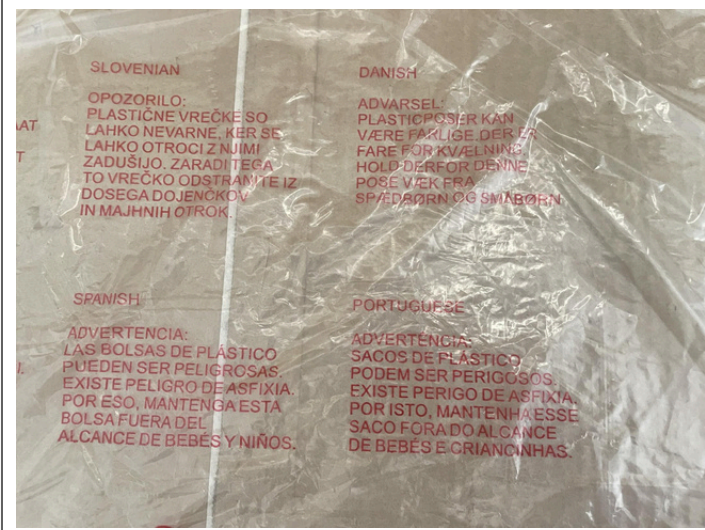
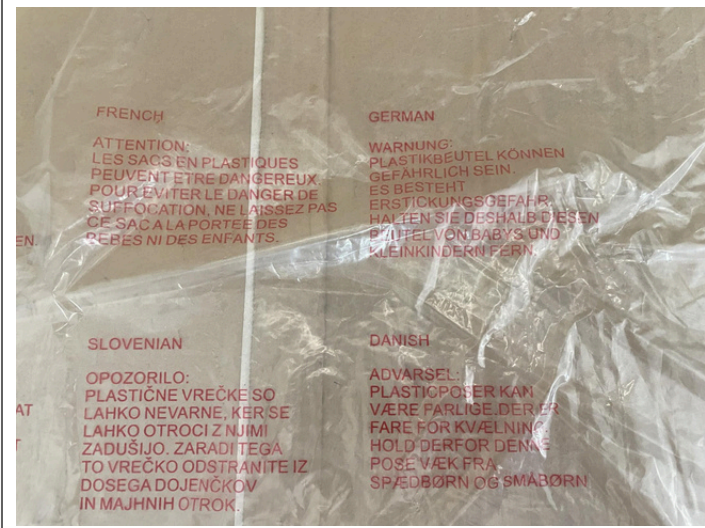
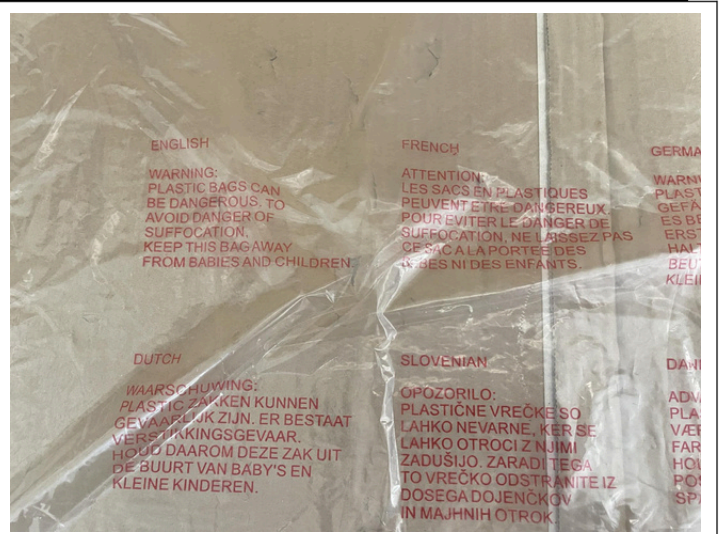





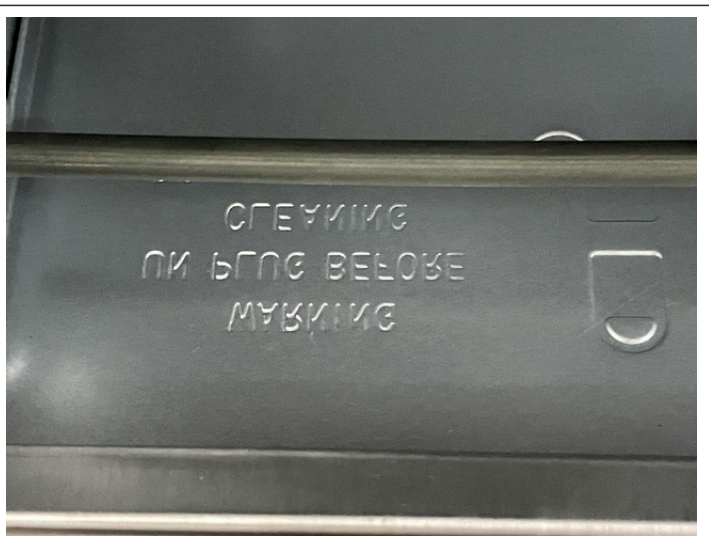

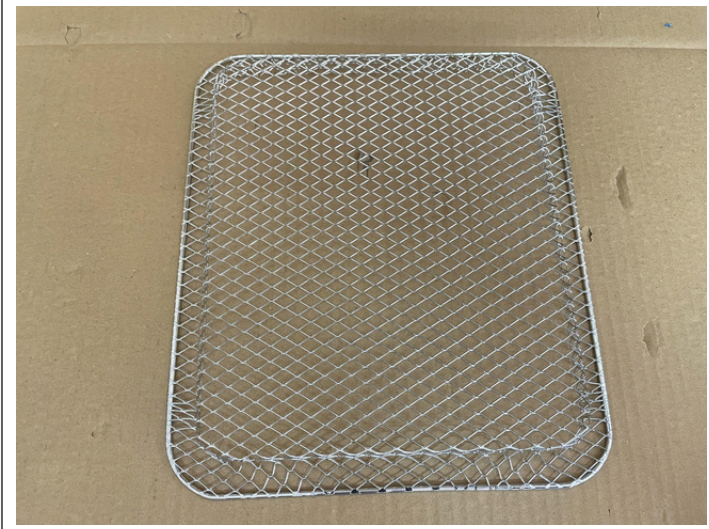

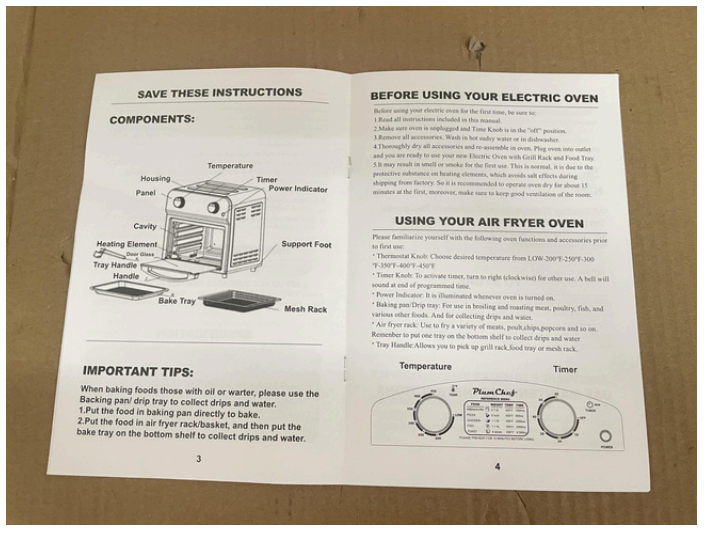
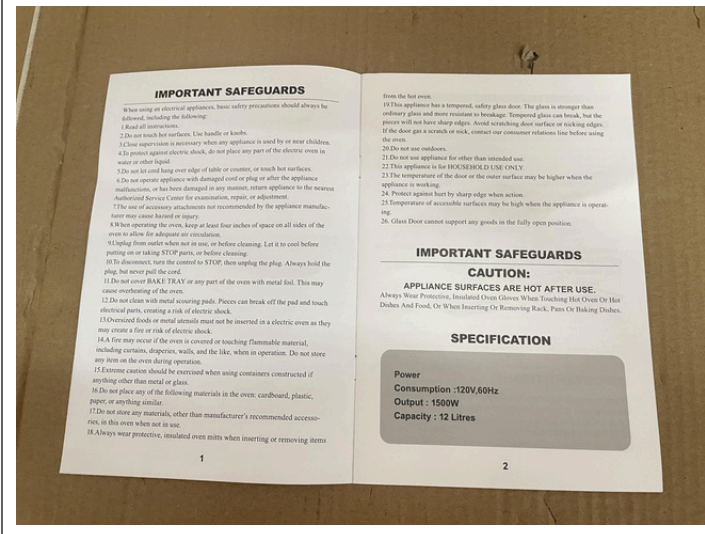
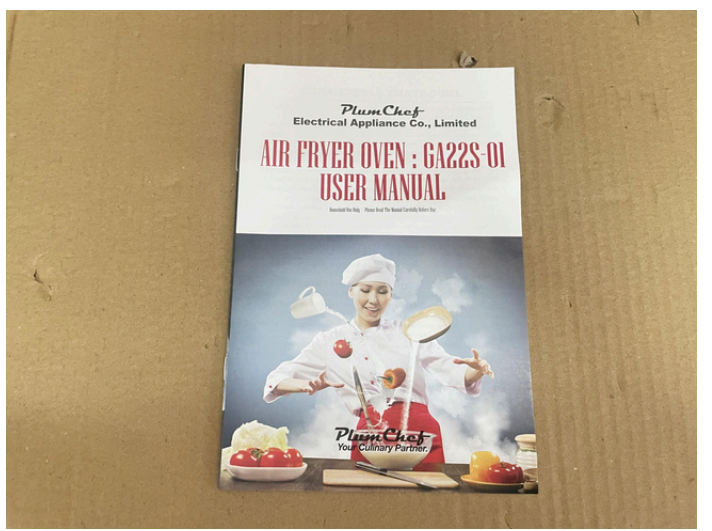
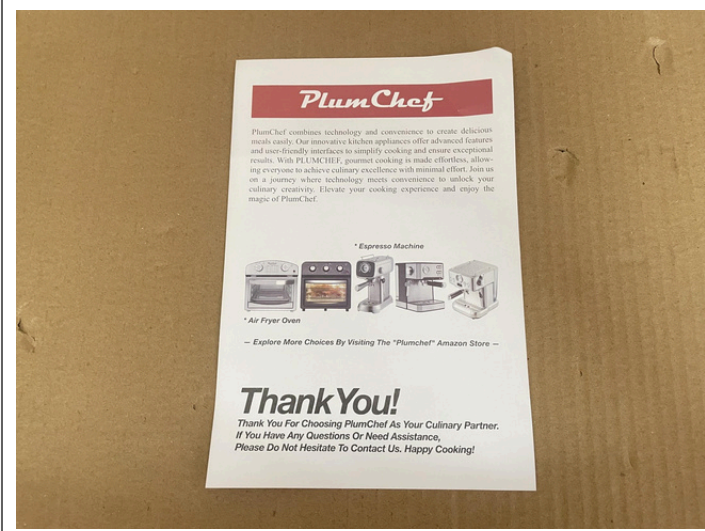
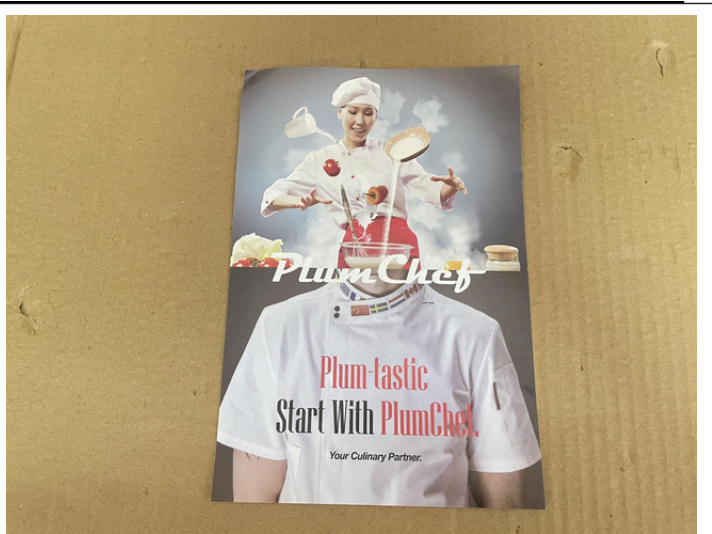

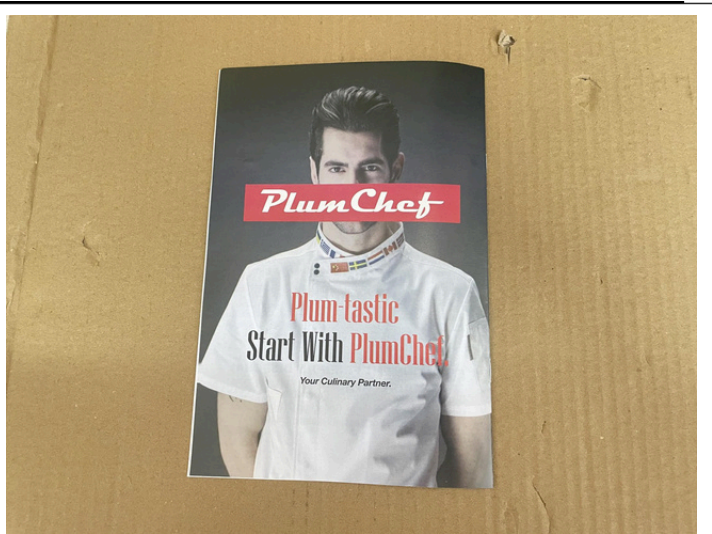
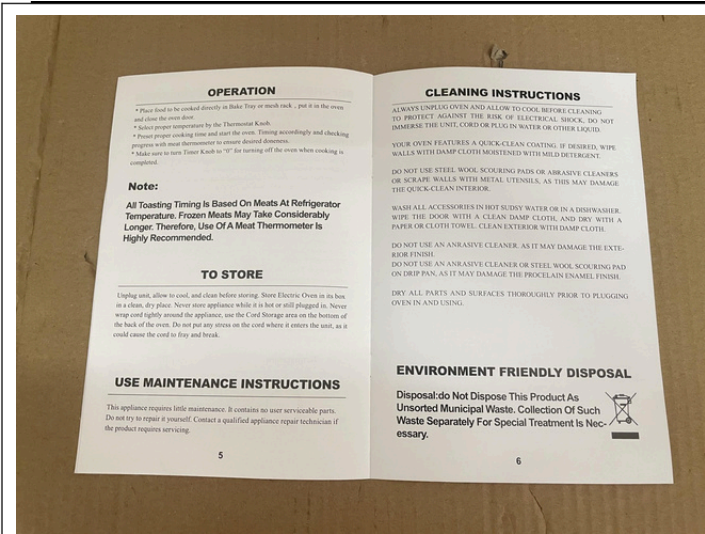



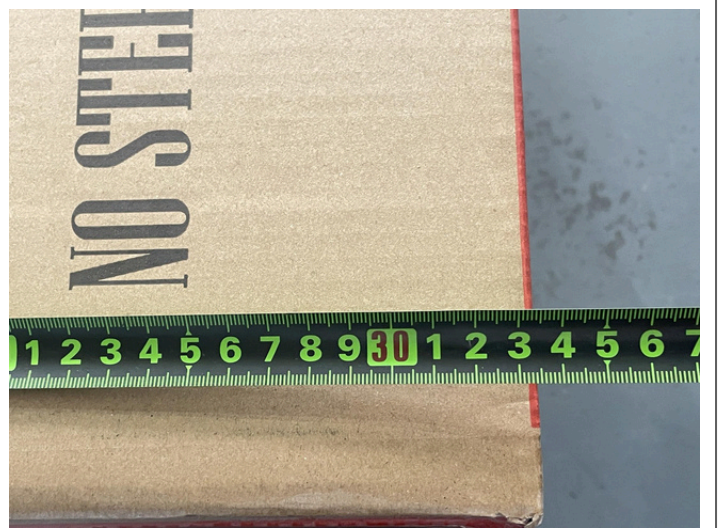
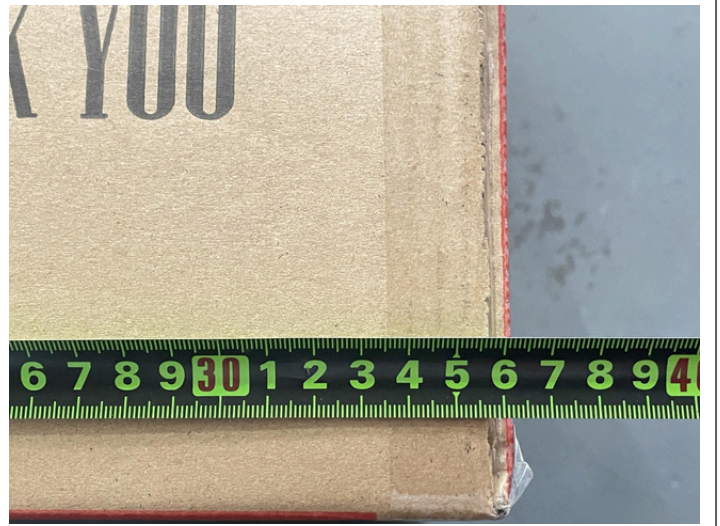

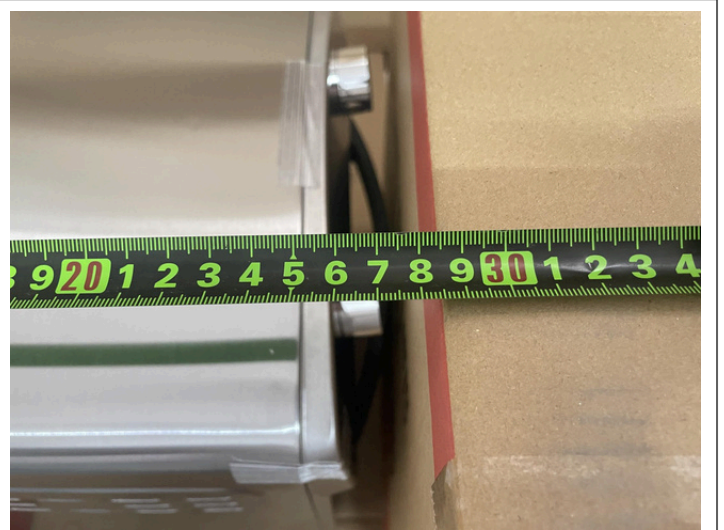
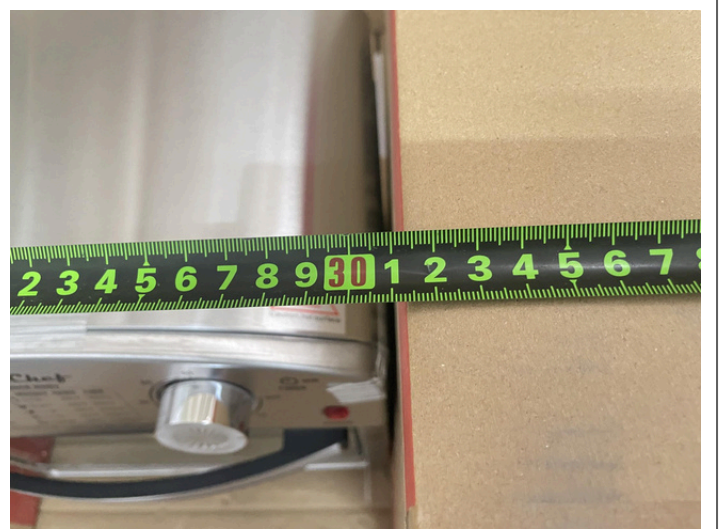
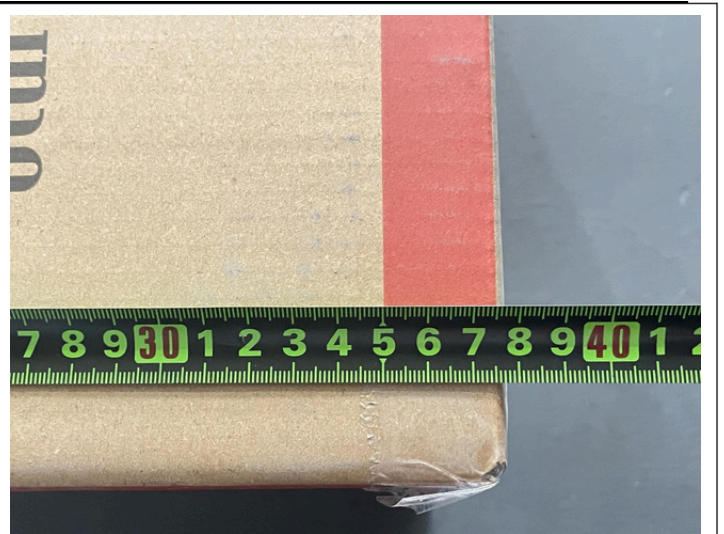





TESTING /CHECKING

Inspection Standard: ANSI/ASQZ1.4 (MIL-STD-105E)					DEFECTS		
					Critical	Major	Minor
Sampling plan: Single, Normal				AQL Max.	0	0.65	1.5
InspectionLevel:	S-4	Sample Size:	20	Allowed:	0	0	1
InspectionLevel:	S-2	Sample Size:	5	Max. Allowed:	0	0	0

TESTING/CHECKING							
NO	testitem	Insp Level	Sample	CRI	MAJ	MIN	Conclusion
1. 2. 3. 4. 5. 6. 7. 8.	Material test	S-2	5	0	0	0	PASS
9. 10.	Ageing test	S-2	5	0	0	0	PASS
11.	Barcode check	S-2	5	0	0	0	PASS
	Function test	III	125	0	0	0	PASS
	Hi-pot test	III	125	0	0	0	PASS
	Power test	III	125	0	0	0	PASS
	Pull test on power cord	S-2	5	0	0	0	PASS
	Rub test	S-2	5	0	0	0	PASS
	Temperature test	S-2	5	0	0	0	PASS
		S-2	5	0	0	0	PASS
		---	1pc	0	0	0	PASS

[Pictures & instructions](#)



Internal check



Internal check



Internal check



Internal check



Internal check



Internal check



Internal check

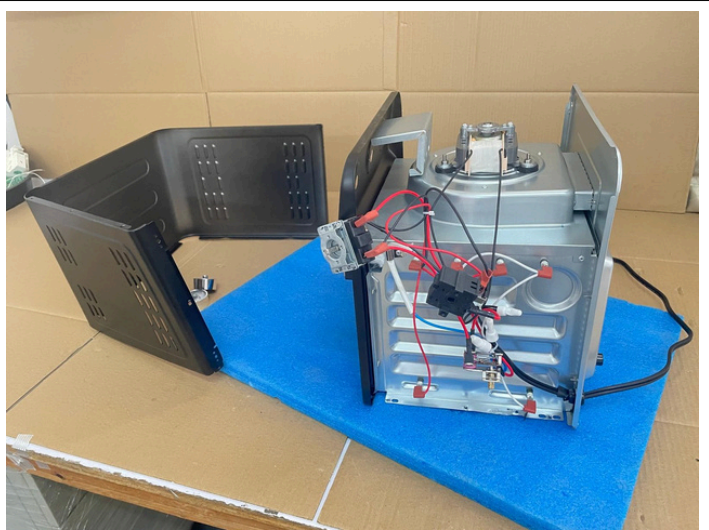

Internal check

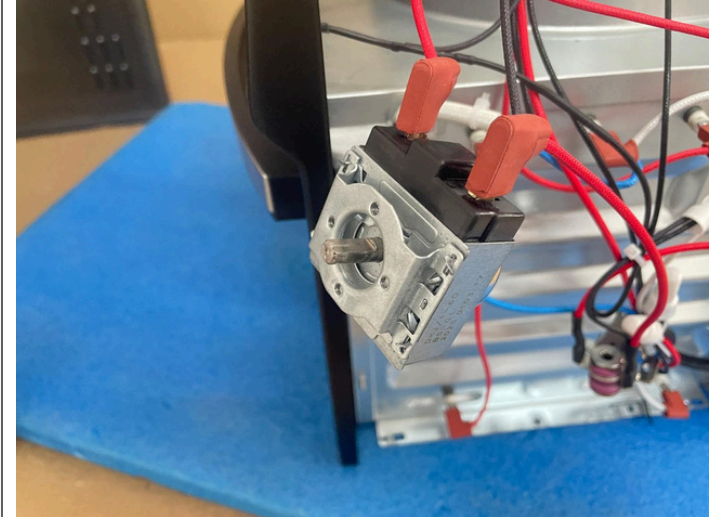

Internal check



Internal check

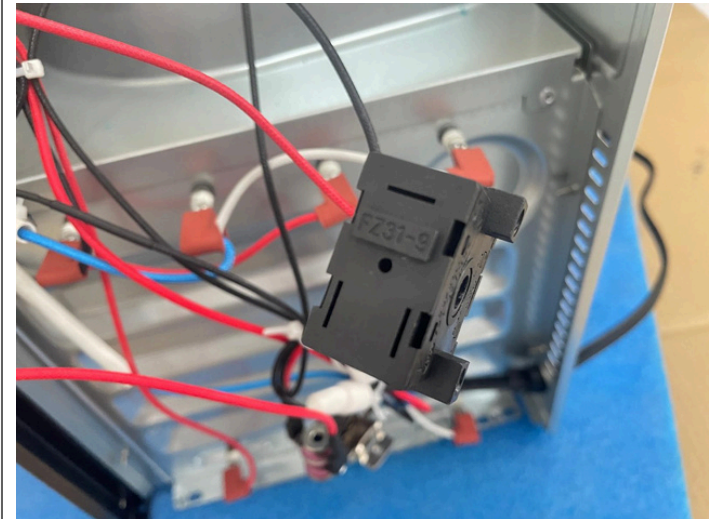

Internal check



Internal check



Internal check

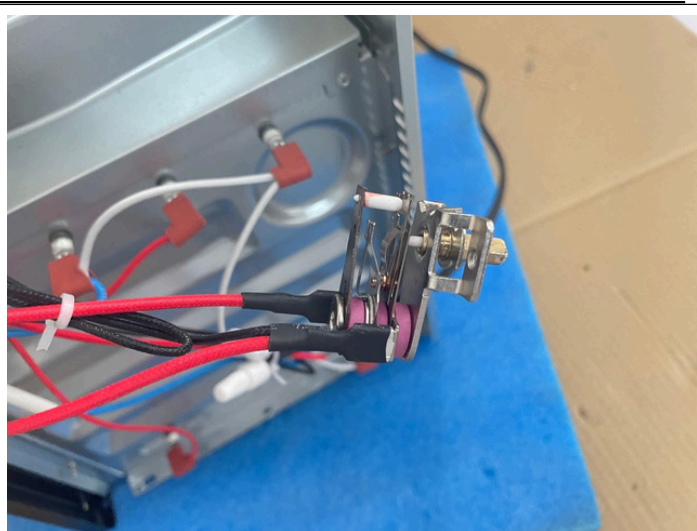

Internal check



Internal check



Internal check

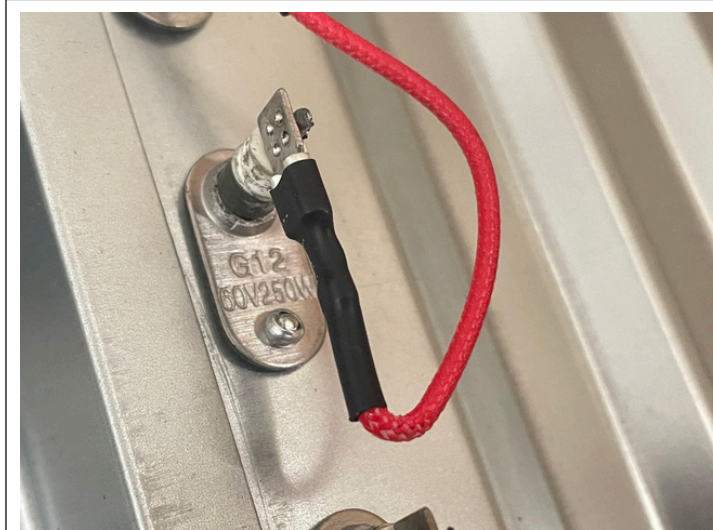

Internal check



Internal check



Internal check

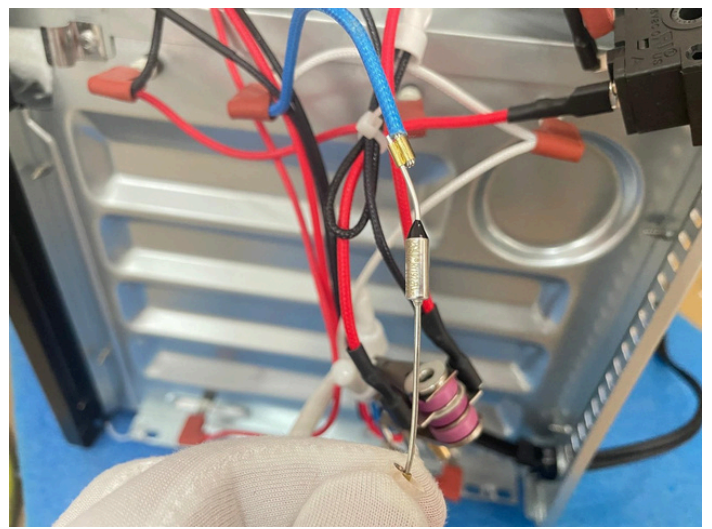

Internal check

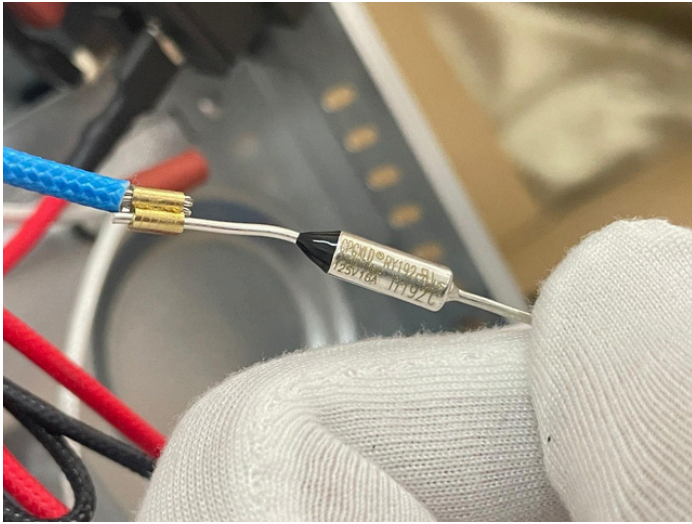

Internal check

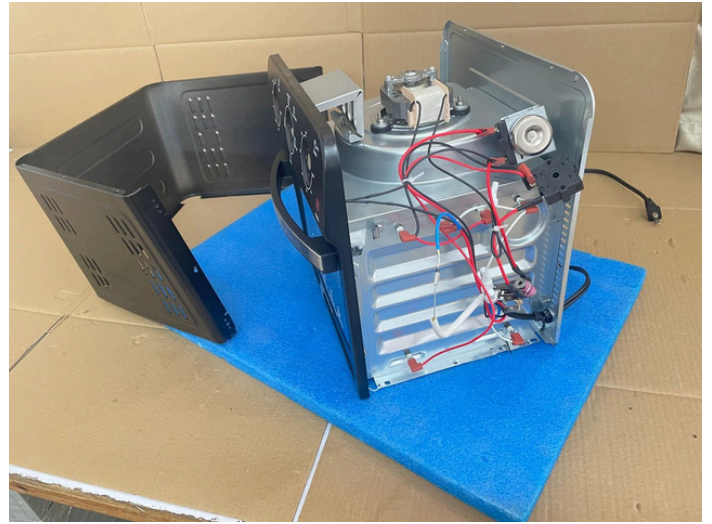

Internal check



Barcode scan test

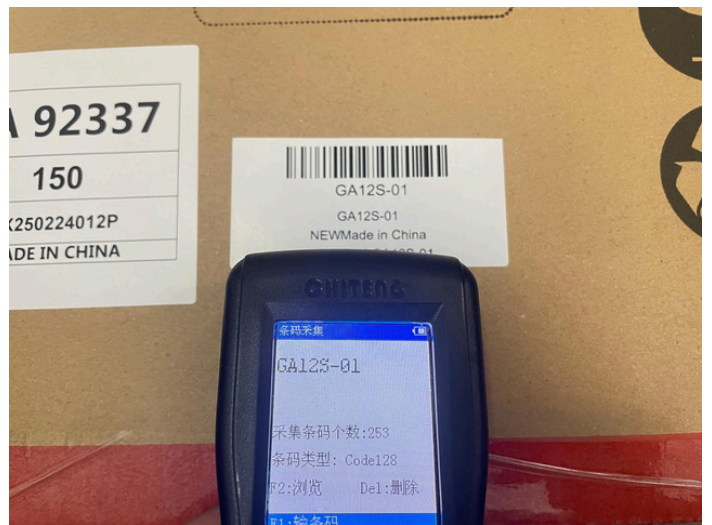

Barcode scan test

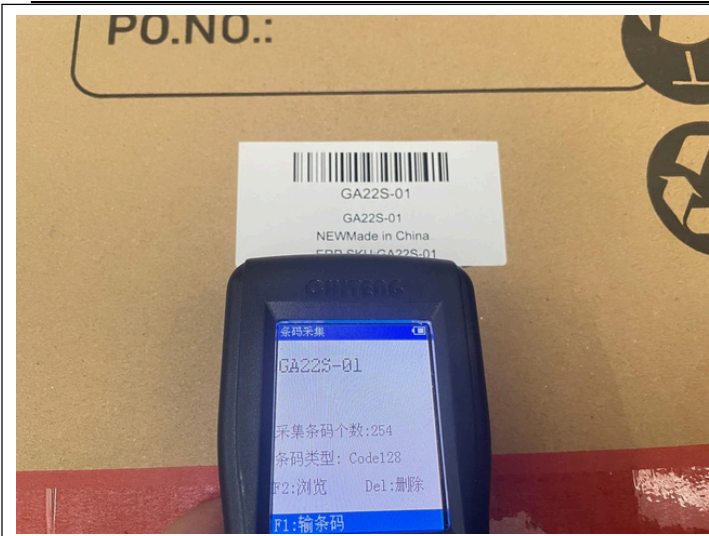

Barcode scan test



Barcode scan test



Barcode scan test



Barcode scan test



3M tape test

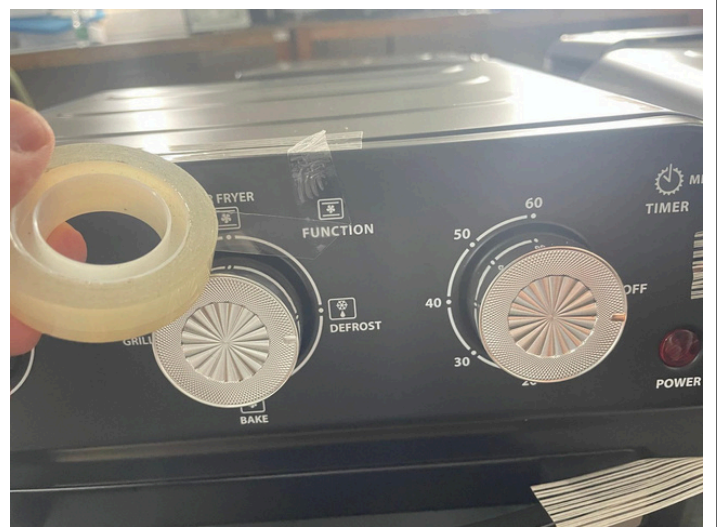

3M tape test



3M tape test



3M tape test



3M tape test



3M tape test



3M tape test



3M tape test

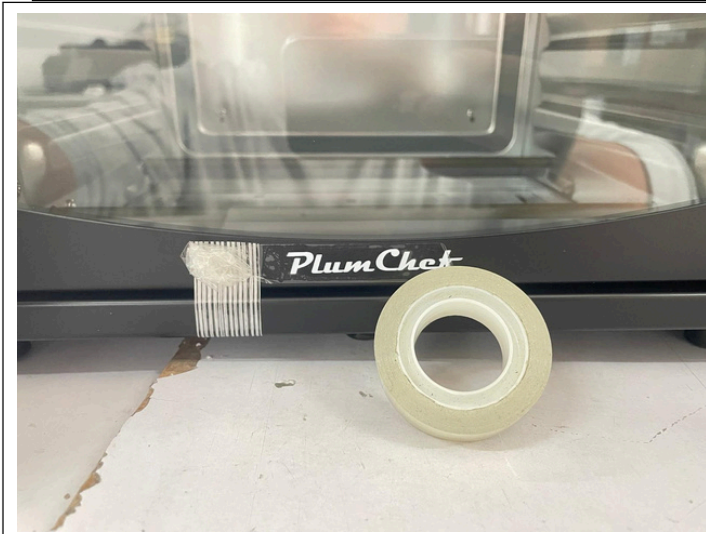

3M tape test



3M tape test



3M tape test



3M tape test



Rub test



Rub test



Rub test



Rub test



Rub test



Rub test



Rub test



Rub test



Rub test



Rub test



Rub test



Rub test



Rub test



Rub test



Rub test



Rub test



Aging test



Aging test



Hi-pot test

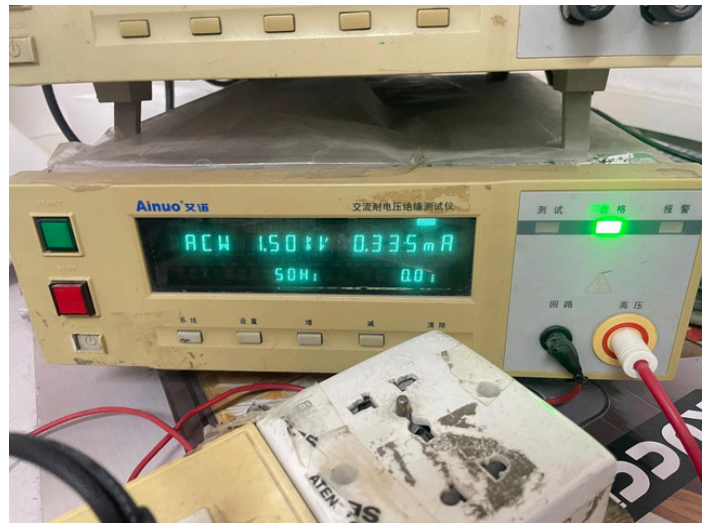

Hi-pot test



Hi-pot test

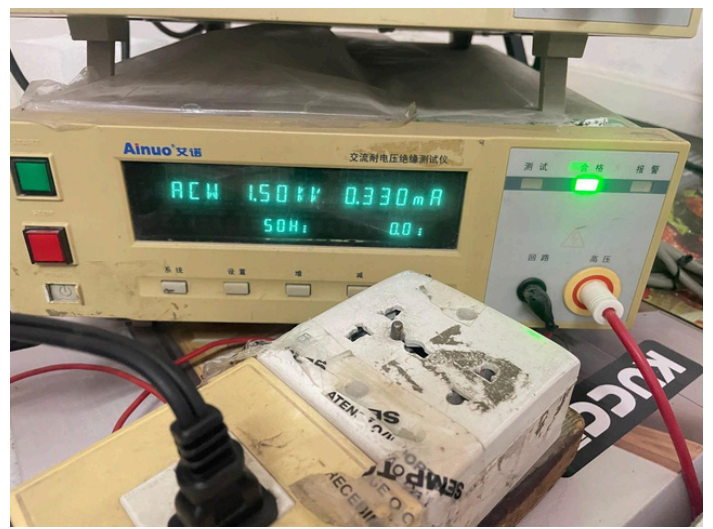

Hi-pot test



Hi-pot test



Hi-pot test



Power test



Power test



Power test



Power test



Power test

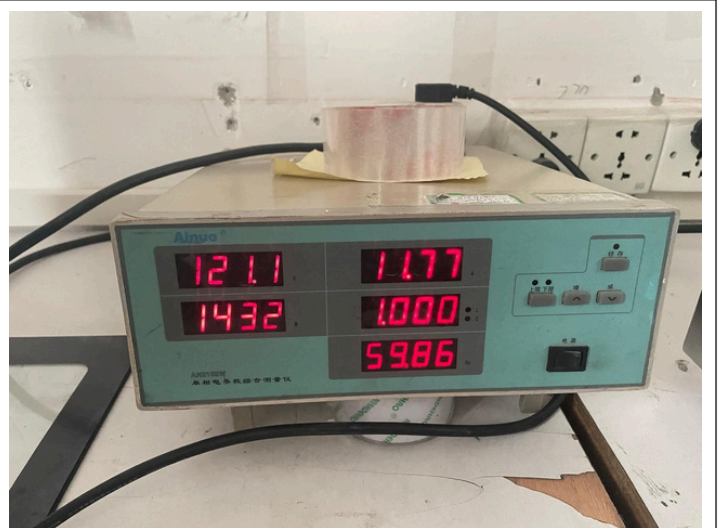

Power test



Power test



Power test



Power test

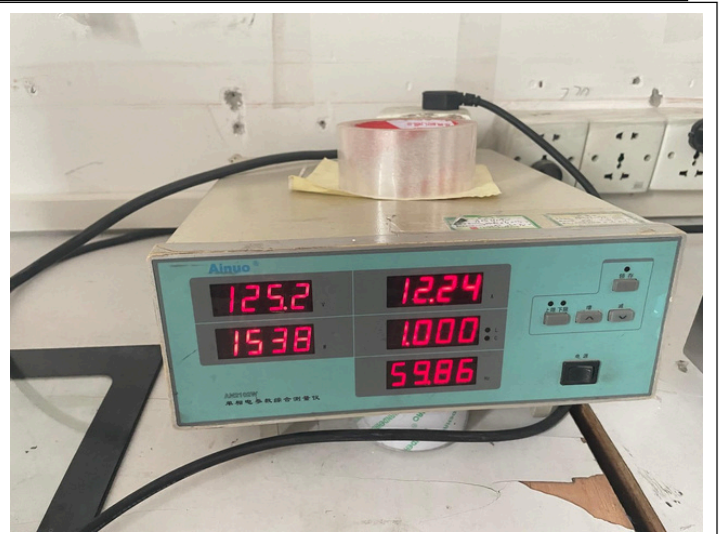

Power test



Function test



Function test



Function test



Function test



Function test



Function test



Function test



Function test



Function test



Function test



Function test



Function test



Function test



Function test



Function test



Function test



Function test



Function test



Function test



Function test



Temperature test



Temperature test

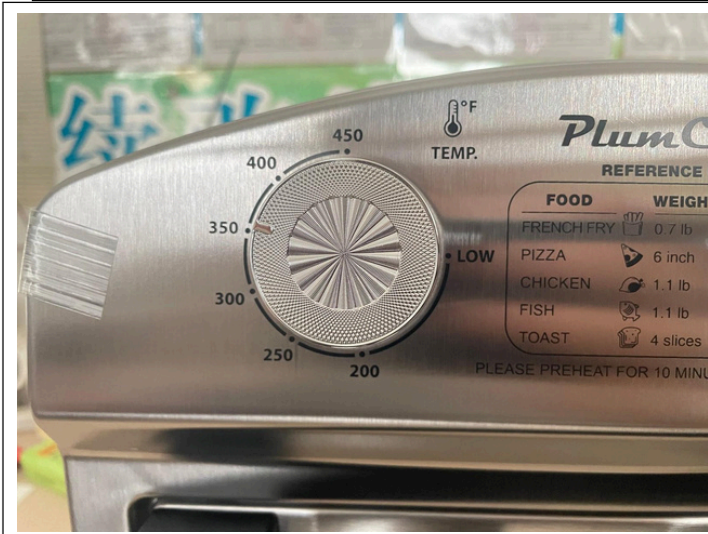

Temperature test



Temperature test



Temperature test



Temperature test



Temperature test

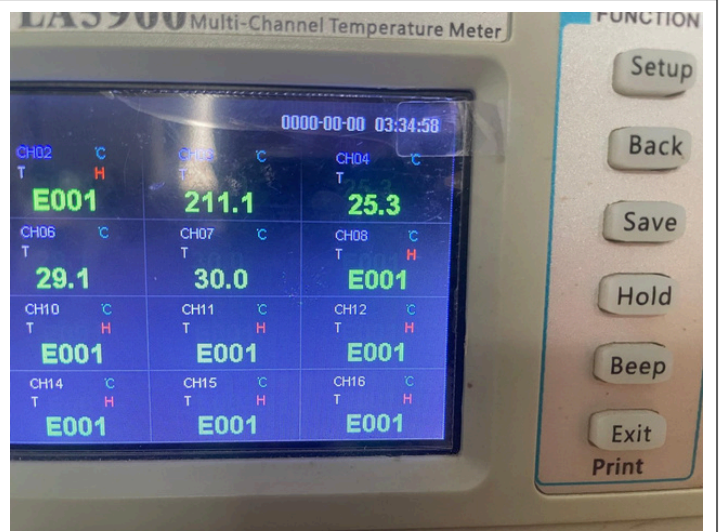

Temperature test

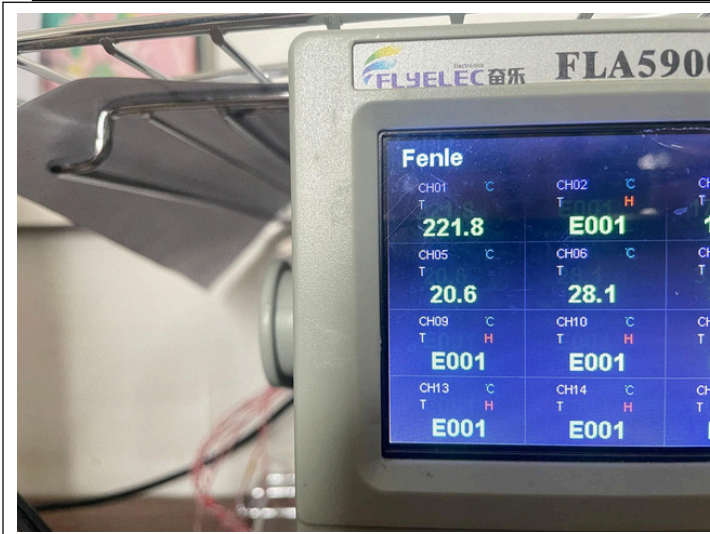

Temperature test



Timing test

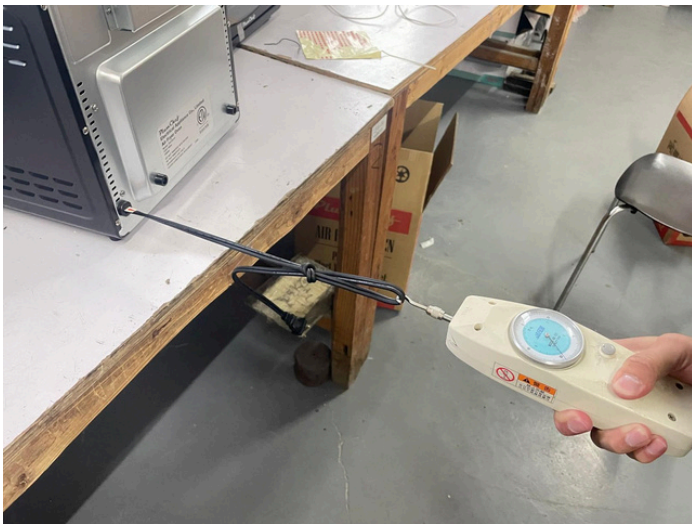

Pull test on power cord



Pull test on power cord



Pull test on power cord

NA

NA

Cartons



Warehouse



Warehouse



Warehouse



Warehouse

INSEPCION SPOT



Random sampling



Random sampling

Random sampling



Random sampling

-----END OF REPORT-----